

## Welcome!

We greatly appreciate your purchase of the PNP300/350 Pop 'N Plug Slim Interconnect Box. We are sure you will find it reliable and simple to use. Superior performance for the right price, backed by solid technical and customer support is what ALTINEX has to offer.

We are committed to providing our customers with Signal Management Solutions® to the most demanding audiovisual installations at very competitive pricing and we welcome you to join the ranks of our many satisfied customers throughout the world.

## 1. Precautions and Safety Warnings

Please read this manual carefully before using your PNP300/350 and keep it handy for future reference. These safety instructions are to ensure the long life of your PNP300/350 and to prevent fire and shock hazards. Please read them carefully and heed all warnings.

### 1.1 General

- Do not open the unit or power supply case there are high-voltage components inside.
- There are no user serviceable parts inside. Qualified ALTINEX service personnel must perform all service on the Pop 'N Plug.

### 1.2 Installation Precautions

- For best results, place in a dry area away from dust and moisture.
- To prevent fire or shock, do not expose to water or moisture. Do not place in direct sunlight, near heaters, or heat-radiating appliances, or near any liquid. Exposure to direct sunlight, smoke, or steam can harm internal components.
- Handle the unit carefully. Dropping or jarring can cause damage.
- Do not pull any cables that are attached to the PNP300/350 and do not place heavy objects on top of the PNP300/350.

## 2. Installation Procedures

- Step 1. Cut an opening into the table's surface. Refer to the ALTINEX website at [www.altinex.com](http://www.altinex.com) for the cutout requirements. The table can be 0.25 in (6 mm) to 3.75 in (95 mm) thick. Always confirm dimensions before cutting to ensure that specifications have not changed.
- Step 2. Place the support brackets under the table and place them between the support mount grooves on the side of the PNP300/350 unit. Attach the brackets to the groove at the desired height and secure them to the bottom of the table using the setscrew. There are two support brackets, one for each side.
- Step 3. Secure the cables by using the provided cable clamps as shown.
- Step 4. Pass the power cord from the bottom of the housing and attach it to the bottom of the table using the cable clamp and screw supplied with the PNP300/350. Do NOT clamp the cord too tight or too loose.
- Step 5. Connect the appropriate cables with the correct input connectors on the bottom of the unit. See Table 4 for the standard connections provided.

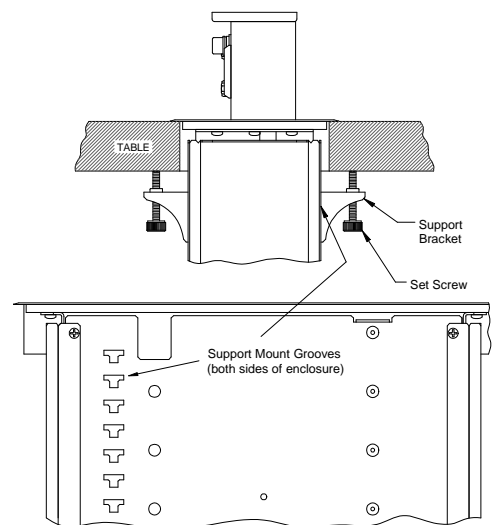
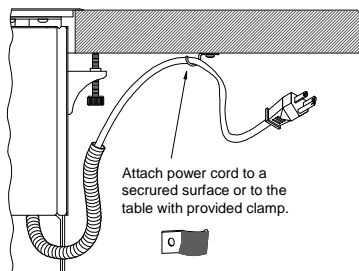

- Never place fingers inside the openings of the unit.
- If the PNP300/350 interface is not used for an extended period, disconnect from AC power to avoid fire, shock, and loss of power.
- We recommend using wall outlets with a Ground Fault Circuit Interrupter (GFCI) for maximum protection.

### 1.3 Cleaning

- Unplug the PNP300/350 before cleaning and clean only with a dry cloth. Never use strong detergents or solvents such as alcohol or thinner. Do not use a wet cloth or water to clean the unit. Do not open to clean.

### 1.4 FCC Notice

- This device complies with Part 15 of the FCC Rules. Operation is subject to the following two conditions: (1) This device may not cause harmful interference, and (2) this device must accept any interference received, including interference that may cause undesired operation.
- This equipment has been tested and found to comply with the limits for a Class A digital device, pursuant to Part 15 of the FCC Rules. These limits are designed to provide reasonable protection against harmful interference when the equipment is operated in a commercial environment. This equipment generates, uses, and can radiate radio frequency energy and, if not installed and used in accordance with the instructions found herein, may cause harmful interference to radio communications. Operation of this equipment in a residential area is likely to cause harmful interference in which case the user will be required to correct the interference at his own expense.
- Any changes or modifications to the unit not expressly approved by ALTINEX, Inc. could void the user's authority to operate the equipment.

## 3. Limited Warranty/Return policies

Please see the ALTINEX website at [www.altinex.com](http://www.altinex.com) for details on warranty and return policies.

## 4. Technical Specifications

Specifications are subject to change. See [www.altinex.com](http://www.altinex.com) for up-to-date information.

Features/Description	PNP300/350
<b>PNP300 Connectors</b> <i>Interface Connection</i>	
AC (NEMA)	5-15R (1)
Computer video	15-pin HD F (1)
Computer audio	3.5 mm F (1)
Composite video	RCA F (1)
Stereo audio	RCA F (2)
Modem	RJ-11 F (1)
Network	RJ-45 F (1)
RS-232 Control	DB9 F (1)
<b>PNP300 Connectors</b> <i>Under the Table</i>	
AC	5-15P (1)
Computer video	15-pin HD M (1)
Computer audio	3.5 mm M (1)
Composite video	RCA M (1)
Stereo audio	RCA M (2)
Modem	RJ-11 M (1)
Network	RJ-45 M (1)
RS-232 Control	DB9 M (1)
<b>PNP350 Connectors</b> <i>Interface Connection</i>	
AC (NEMA)	5-15R (2)
Network	RJ-45 F (6)
<b>PNP350 Connectors</b> <i>Under the Table</i>	
AC	5-15P (2)
Network	RJ-45 M (6)

Table 1. PNP300/350 General

Mechanical	PNP300/350
Minimum Table Thickness	0.25 in (6 mm)
Maximum Table Thickness	3.75 in (95 mm)
Length (bezel)	10.03 in (255 mm)
Width (bezel)	3.39 in (86 mm)
Height (opened, above table)	2.19 in (56 mm)
Depth (below table top)	6.14 in (156 mm)
Finish	Black
T° Operating (T° Max)	10°C-40°C (50°C)
Humidity	90% non-condensing

Table 2. PNP300/350 Mechanical

Electrical	PNP300/350
PNP300	90-140 VAC, 5A Max.
PNP350 (each outlet)	90-140 VAC, 5A Max.

Table 3. PNP300/350 Electrical

Standard Connections	PNP300/350
<b>PNP300 *</b>	
AC power cable	AC Power
Black RCA cable	Audio Left
Red RCA cable	Audio Right
Yellow RCA cable	Composite Video
Black 15-pin HD	Computer Video
DB9 cable	Serial Data
Red RJ-45 cable	Network
Silver RJ-11 cable	Telephone/Modem
<b>PNP350</b>	
AC power cable	AC Power
Red RJ-45 cables	Independent Network Connections

Table 4. PNP300/350 Standard Connections

\* A round gray cable is also provided for connection to a stereo audio line.

## 5. About Your PNP300/350

The PNP300/350 is designed for installation in a conference room table, podium, or anywhere computer audio, video, and communications connections are needed. The Pop 'N Plug Slim provides a means of connecting audio, video, control, and computer video sources into a presentation system. It is ideal for use together with ALTINEX computer video interfaces.

The PNP300/350 Pop 'N Plug Slim interconnect "pops up" into a raised position to provide access to connectors. When not in use, it is lowered into the tabletop providing a clean, smooth finish. The PNP300/350 uses a tower-type construction with a pneumatic suspension and a mechanical latching mechanism.

The PNP300 has one input plate on the front panel of the unit. The standard plate offers input connections for the following: AC power (NEMA 5-15R), computer video (15-pin HD), composite video (RCA), stereo audio (RCAx2), computer audio (3.5 mm stereo), modem (RJ-11), RS-232 (9-pin D-sub), and network (RJ-45). All signals pass from the interface plate, through standard cables, and terminate in the mating connector for easy connection to the audiovisual system.

The PNP350 Interconnect Box has one input plate on the front panel of the unit. The standard plate offers 2 AC power outlets and 6 RJ-45 network snap-in connectors. All interface connections include pass-through connectors and cables.

The Pop 'N Plug Slim Interconnect Boxes are designed for use with tabletops ranging from 0.25 in (6 mm) to 3.75 in (95 mm) thick..



The PNP300 is shown above.

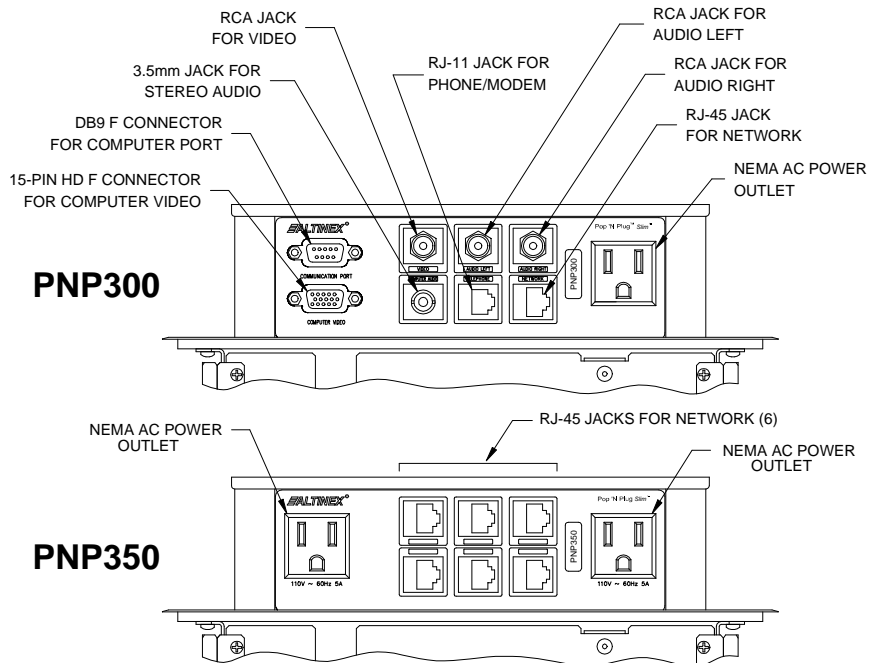

## 6. Application Diagrams

### Diagram 1: Typical Setup

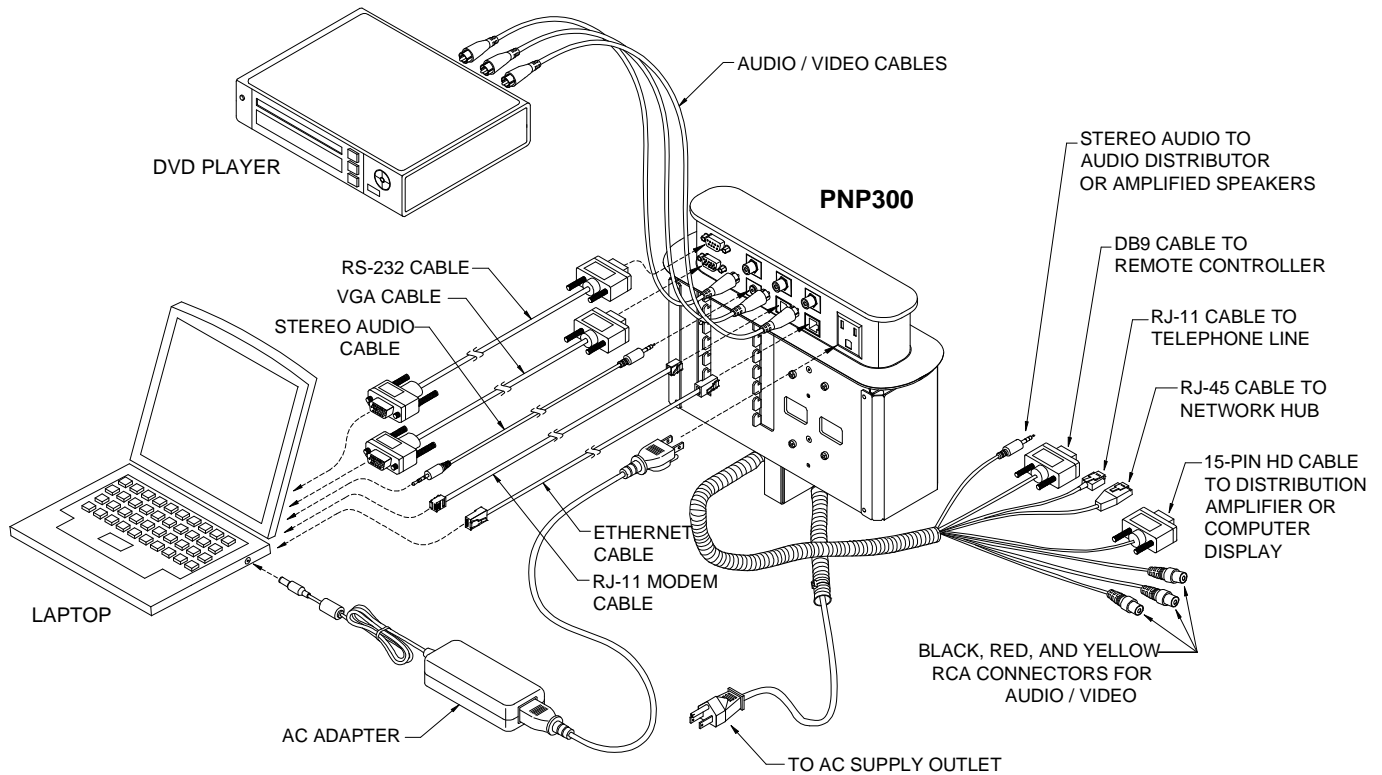

## Diagram 2: Dimensions

The PNP300 Faceplate is shown here.

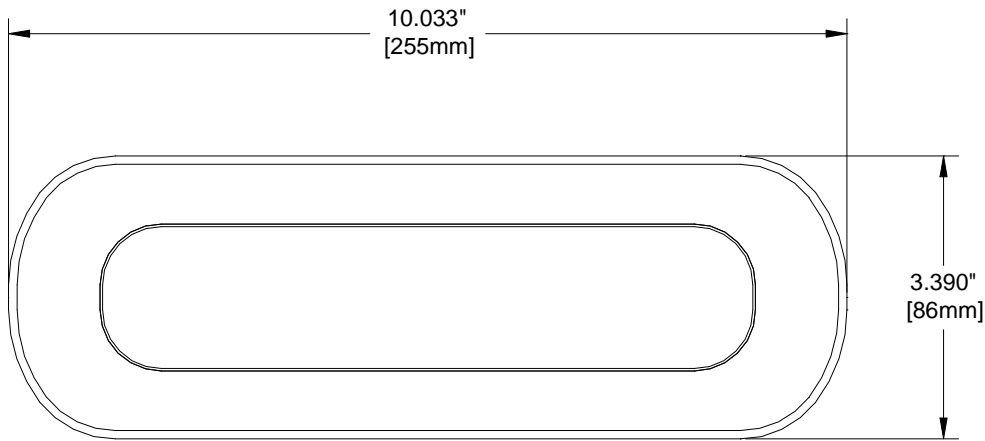

TOP VIEW

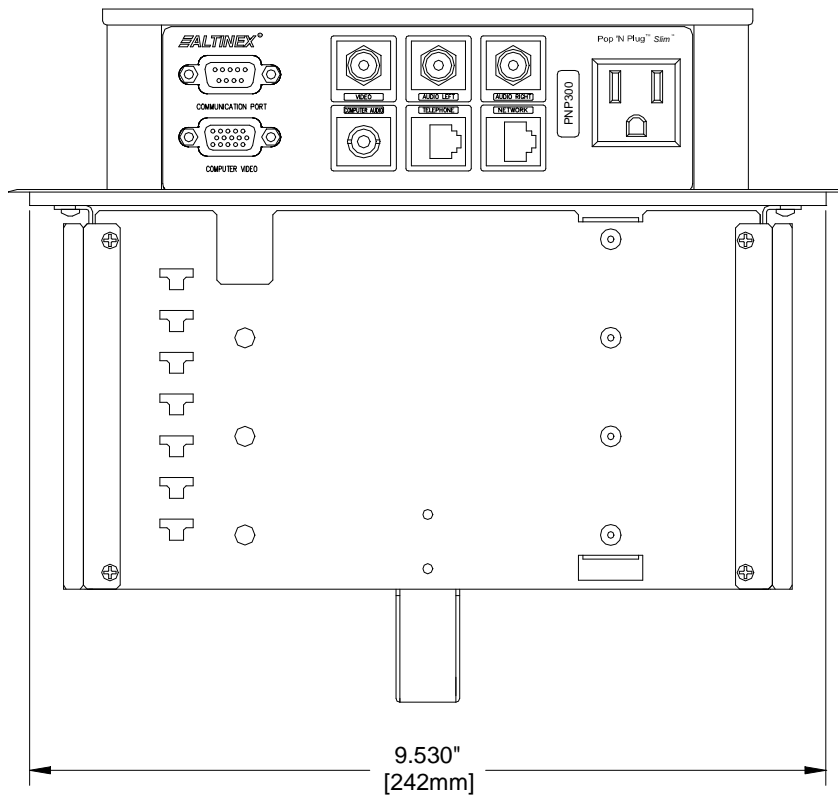

FRONT VIEW  
(OPEN POSITION)

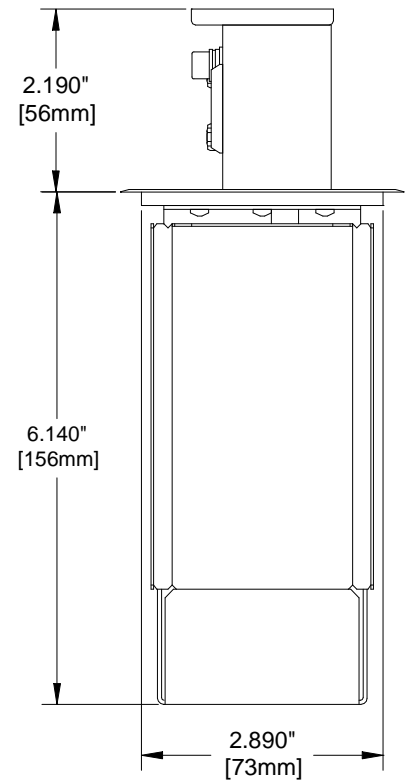

SIDE VIEW  
(OPEN POSITION)

### 7. Operation

#### 7.1 Operating the Pop-Up Panel

To raise the unit, push down on the center of the top cover of the PNP300/350 until a click is heard and then let go. The connector panel will pop up to allow access to the connectors.

To lower the unit, disconnect all cables on the front connector panel. Then push down on the center of the top cover until the latch engages and the unit is locked in place.

### 8. Troubleshooting Guide

The PNP300/350 supplied unit was carefully tested and no problems were detected; however, we would like to offer these suggestions.

- Please make sure that the highest quality video, audio, network, and telephone cables or connectors are used.
- Make sure that no cable or power cord is damaged or pinched. If there has been damage, then do not use the PNP300/350 unit. Immediately contact the ALTINEX Customer Service Department to have the unit repaired.